

Sorrento

West Kowloon

The Sorrento residential development is a five-tower project located at the northern side of Kowloon Station and facing Jordan Road. The first phase of the project will see Towers 3, 5 and 6 developed above an eight-storey podium and offering housing up to the 71st, 69th and 67th floors respectively. Units in the development range

in size between 800 sq ft to more than 1,200 sq ft.

Towers 1 and 2, to be developed in the second phase, will rise to their 81st and 71st floors respectively.

Tower lobbies are located above the podium car parking levels and are accessible via escalator from the main entrance below.





擎天半島 西九龍



由五幢樓宇組成的擎天半島住宅項目，坐落地鐵九龍站北面，面向佐敦道。第一期發展嶄露頭角的是蓋於八層高平台上的第三、五、六座，分別有71、69、及67層之高。單位面積介乎800平方呎至逾1,200平方呎之間。

第二期推出的第一、二座將分別樓高81及71層。

住宅大堂位於停車場平台上，可通過大堂的扶手電梯通往下層的正門入口。住客享用的戶外設施設於六樓平台，包括主題花園、閒坐空間、室外泳池、網球場及遊樂場。一期設於七樓的會所內包括各項消閒活動室及遊樂區、社交舞及遊戲室、多用途宴會廳、互聯網休閒雅座、太極園、蒸氣及桑拿浴室、健身及更衣室等。



Residents' outdoor facilities on the 6th floor podium deck include themed gardens, sitting out areas, outdoor pools, a tennis court and play areas. Seventh floor clubhouse facilities in Phase 1 include further recreation rooms and play areas as well as music and games rooms, function rooms, an Internet lounge, a tai chi court, steam and sauna rooms, a gymnasium and changing rooms.



section

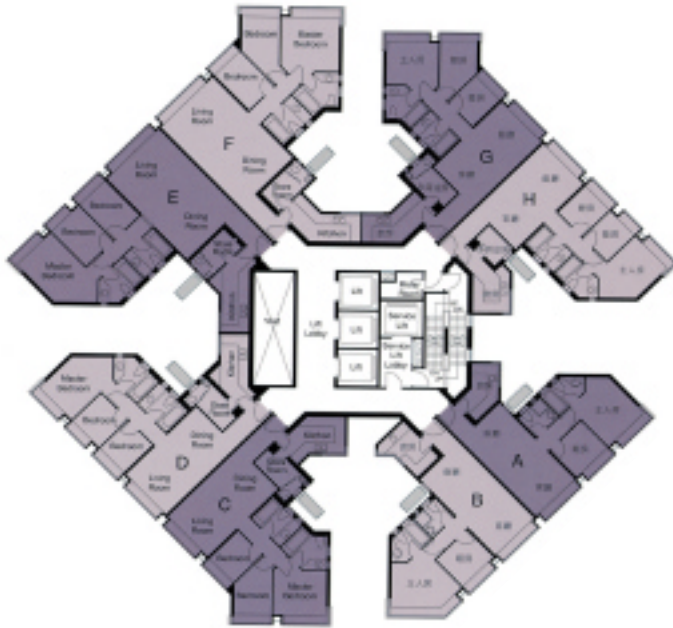

Wharf Group and the MTR Corporation
lead developers

Wong & Ouyang (HK) Ltd
architect

Hip Hing Construction
main contractor

February 2003 (Phase 1)
completion date

Kitchens

- Cabinets — SieMatic
- Countertops — Surell
- Refrigerators — Siemens
- Microwave ovens — Siemens
- Washer/dryers — Siemens
- Gas hobs — Siemens

Bathrooms

- Bathtubs — Kohler
- Toilets — Jacob Delafon
- Counter wash basins — Kohler
- Sanitary ware — Grohe
- Gas water heater — Rinnai
- Master bathroom walls — Rak

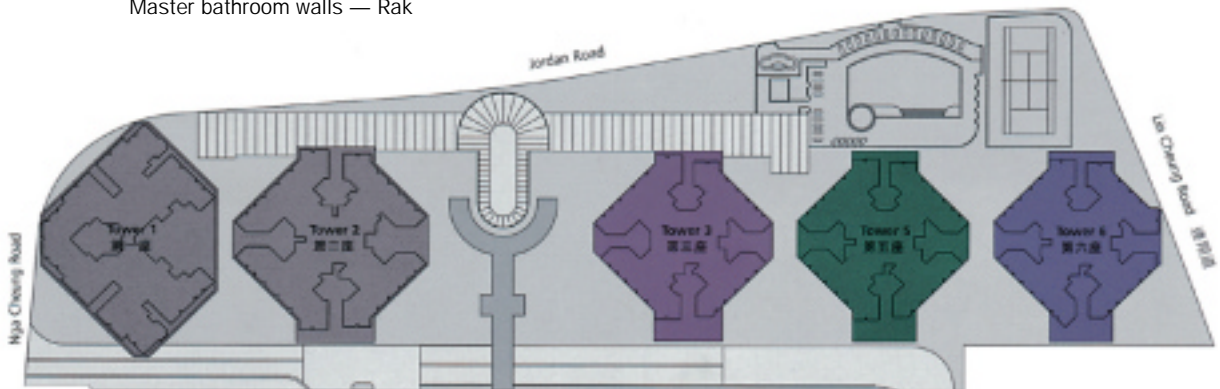

block plan