

Caribbean Coast

Tung Chung

The Caribbean Coast development in Tung Chung will include 13 high-rise towers and an additional ten low-rise buildings on completion. Buildings are oriented to take full advantage of the seaview, with the lower buildings placed closer to the shoreline. The first phase of the development, comprising 1,552 units in four towers, is located towards the northeastern end of the





映灣園

東涌

site and will complete in November 2002. Units in the tower blocks range in size between 636 sq ft and 1,295 sq ft and include balconies from the 33rd floor up.

The Caribbean Coast development is set apart by the resort-style environment for resident's facilities, complete with extensive greenery and two clubhouses. Named Club Caribbean, 610,000 sq ft of landscaping and clubhouse areas are divided into five zones themed on some of the world's most

位 於東涌的映灣園發展項目，完成後將包括 13 幢高密度樓宇及 10 座低密度住宅。項目在東面盡享海景優勢，而較低的樓宇置於臨近海岸線的一邊。第一期發展包括四座共 1,552 個單位，位處地盤東北端，將於 2002 年 11 月建成。單位面積介乎 636 平方呎及 1,295 平方呎之間，包括第 33 樓起的連露台單位。



Caribbean Coast's five themed zones

picturesque holiday destinations — the Bahamas, Barbados, Jamaica, Cayman Islands and Bermuda. Ethnic artwork, water features, signature colours and lush plantings carry a tropical paradise theme and festive mood while the free-form outdoor swimming pools offer beach-style arrangements in suitable locations. The Jamaica zone, for example features the resort features of a landscaped deck with a 120 m beach-like outdoor swimming pool and sliding pool, in addition to a 30 m indoor swimming pool, a rose garden and a 7 m-high rock-climbing area. The Bermuda area meanwhile offers lots of greenery in facilities such as a children’s playground, a putting-green area and a lawn. Other features in Club Caribbean include a second, smaller beach-style outdoor pool, a 25 m metropolitan art deco-style indoor swimming pool, a Japanese spa and a water cascade equivalent to five storeys high.



映灣園項目的特色是渡假式的居住環境，配合的是一個渡假式及齊備的住客設施，包括廣闊的園林設計及兩個住客會所。名為“Club Caribbean”的映灣園會所，園林及住客會所面積達 610,000 平方呎。為營造度假的氣氛，設計師將會所分為五區，以不同的渡假熱點為主題：巴哈馬、巴巴多斯、牙買加、開曼及百慕達，以彩籃、芥辣黃、橘橙、殷紅及翠綠色調劃分。熱帶花卉配以特色水景及民族藝術戶外雕塑等，營造五種不同的加納比風情，海灘式的不規則形戶外泳池配合項目的地理環境，給住客帶來渡假式的生活環境。以牙買加主題區為例，戶外設置了 120 米戶外園林沙灘泳池及滑水梯，還有 30 米室內游泳池、玫瑰園及 7 米高的攀岩競技牆等設施。而百慕達區則以園林為題，例如兒童遊樂場、休憩綠化地帶及大片草地。其他特色會所設施還包括另一較小的戶外園林沙灘泳池、25 米 metropolitan art deco 全天候泳池、日式香薰泉及五層高的水簾瀑布。



Cheung Kong (Holdings) Limited
developer

Hsin Yieh Architects & Engineers Ltd
architect

Belt Collins Hong Kong Ltd
landscape architect

China Overseas Building Construction Ltd
main contractor

30 November 2002 (Phase 1)
date of completion

typical floor plan

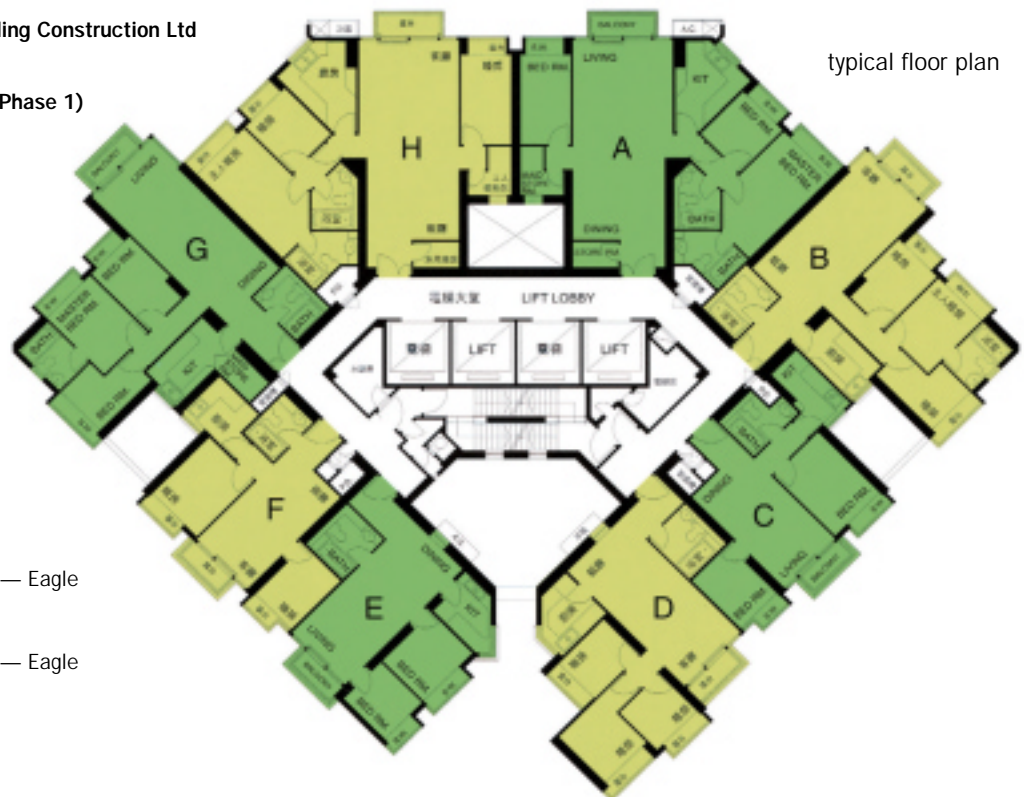

Kitchens

Countertops — Surell
Wall & floor surfaces — Eagle

Bathrooms

Wall & floor surfaces — Eagle